

Pully Video

Video furniture

Assembly instruction

Robert Bronwasser

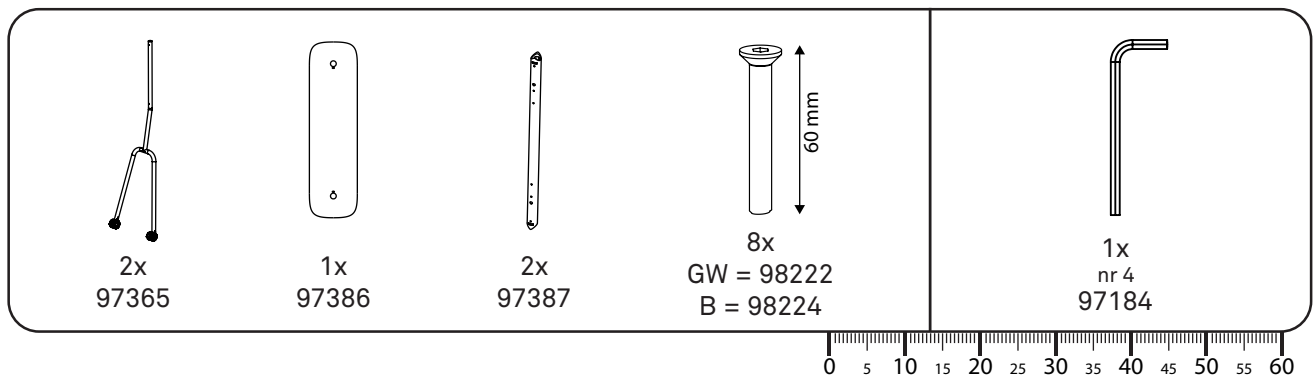

NOTE! Always mount with at least 2 persons! Also leave the protective sleeve on the tube.

Make sure there is enough space underneath the shelf!

approximately 100cm

Also, keep in mind that the leg itself is 175cm high, meaning you need a minimum **ceiling height of 275cm**.

CAUTION before placing the shelf on a table, put something underneath it to prevent scratches.

Be aware of the total height!

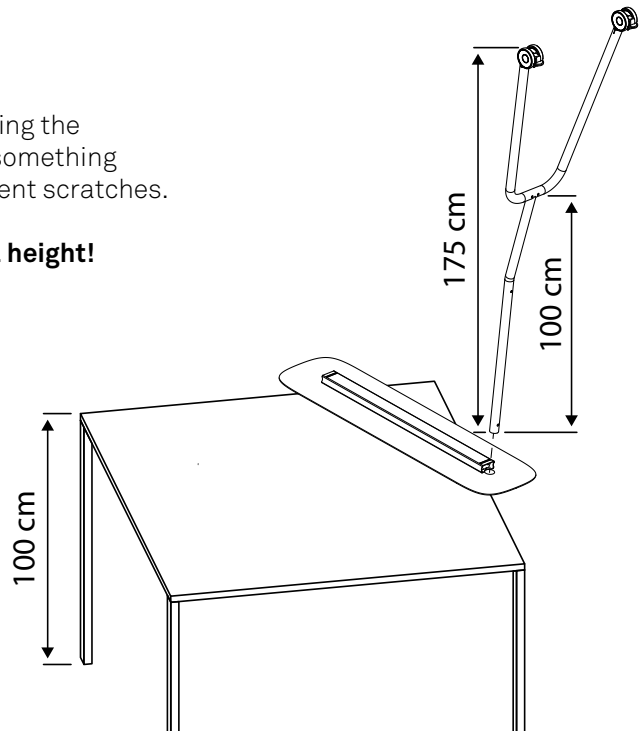

1



NOTE! Always mount with at least 2 persons!

Make sure there is enough space underneath the shelf and check the ceiling height!

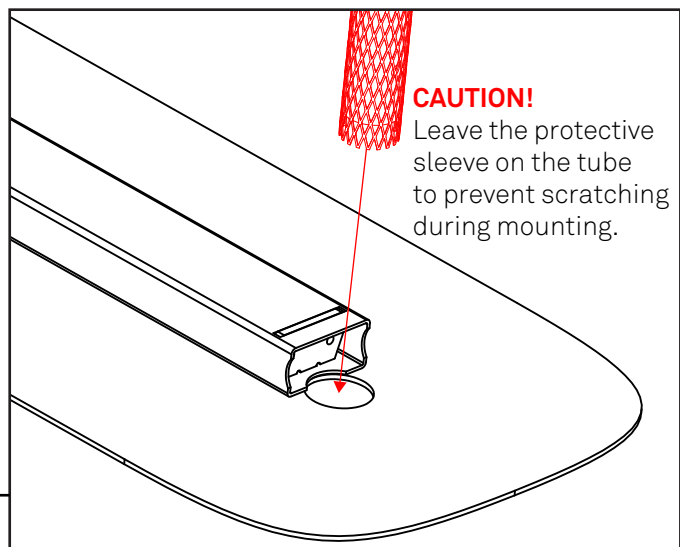
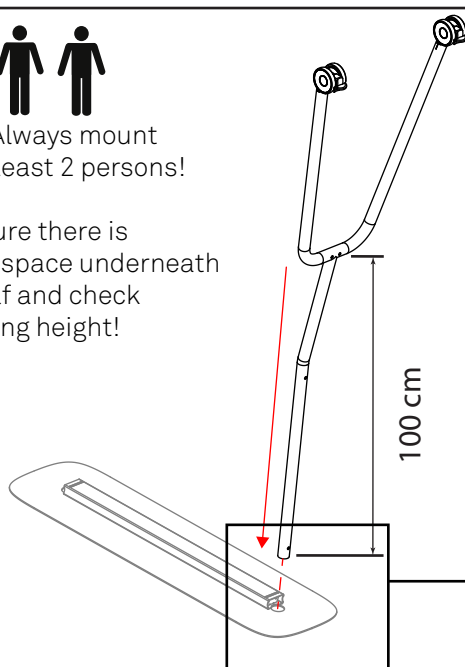

CAUTION!

Leave the protective sleeve on the tube to prevent scratching during mounting.

Cascando®

2

Repeat step 1 & 2 for the left side. Do not fully tighten the screws of upright 2.

Check if the brakes are applied.

Only tighten the screws on upright number 1

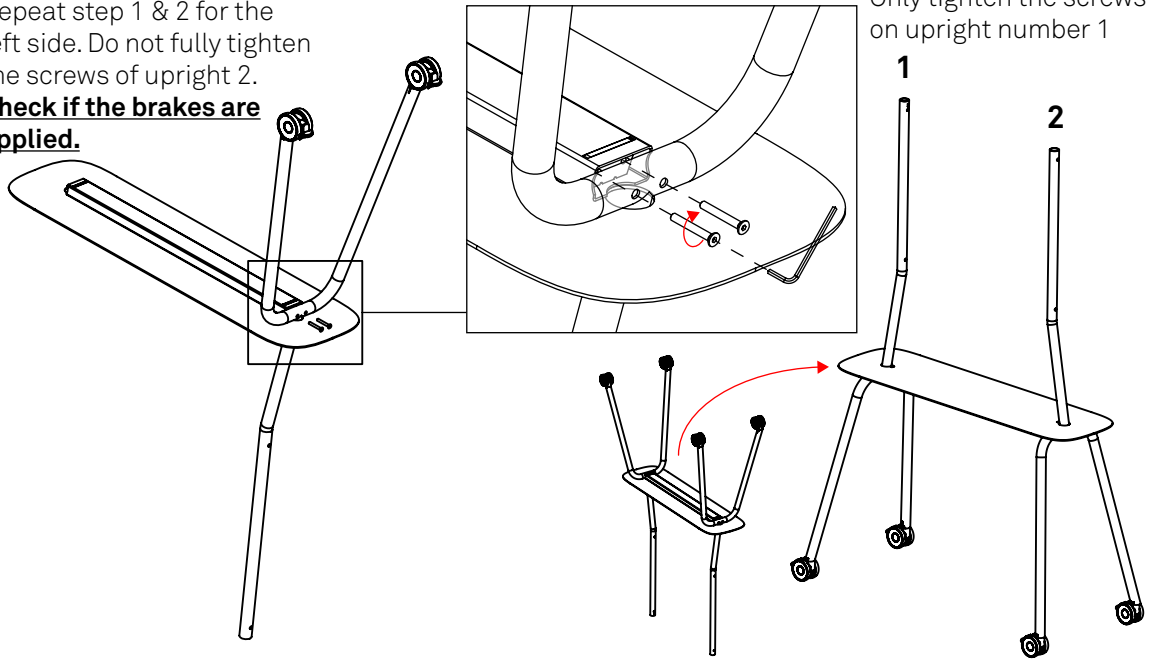

make sure to cover the table top, to prevent scratches when mounting!
For example parts of the packaging.

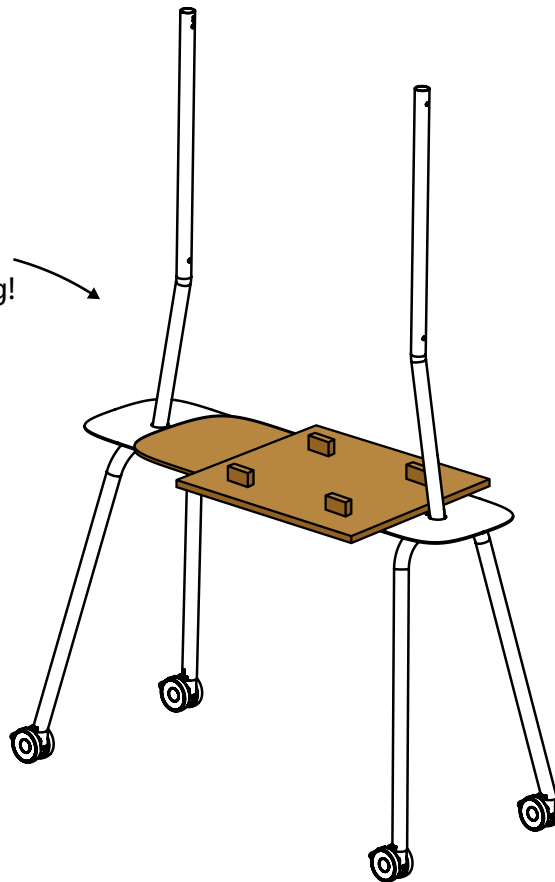

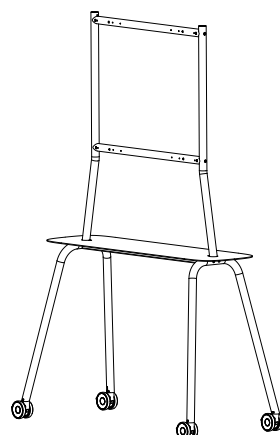
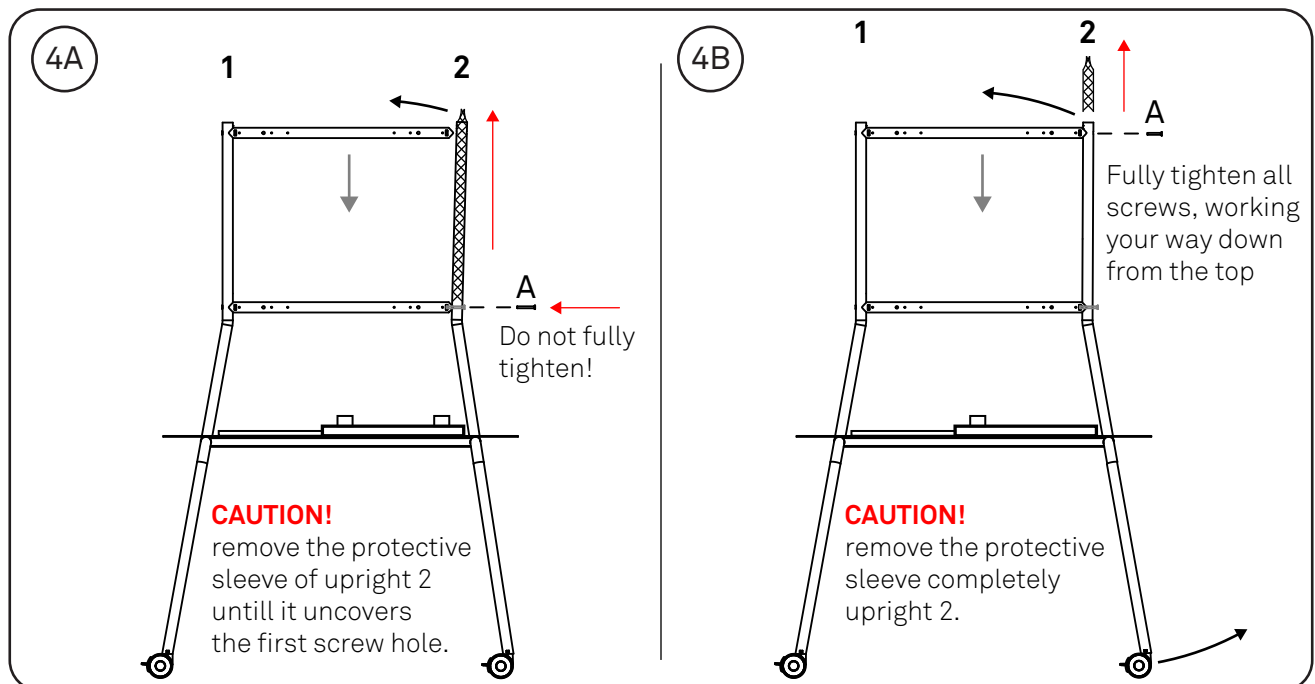
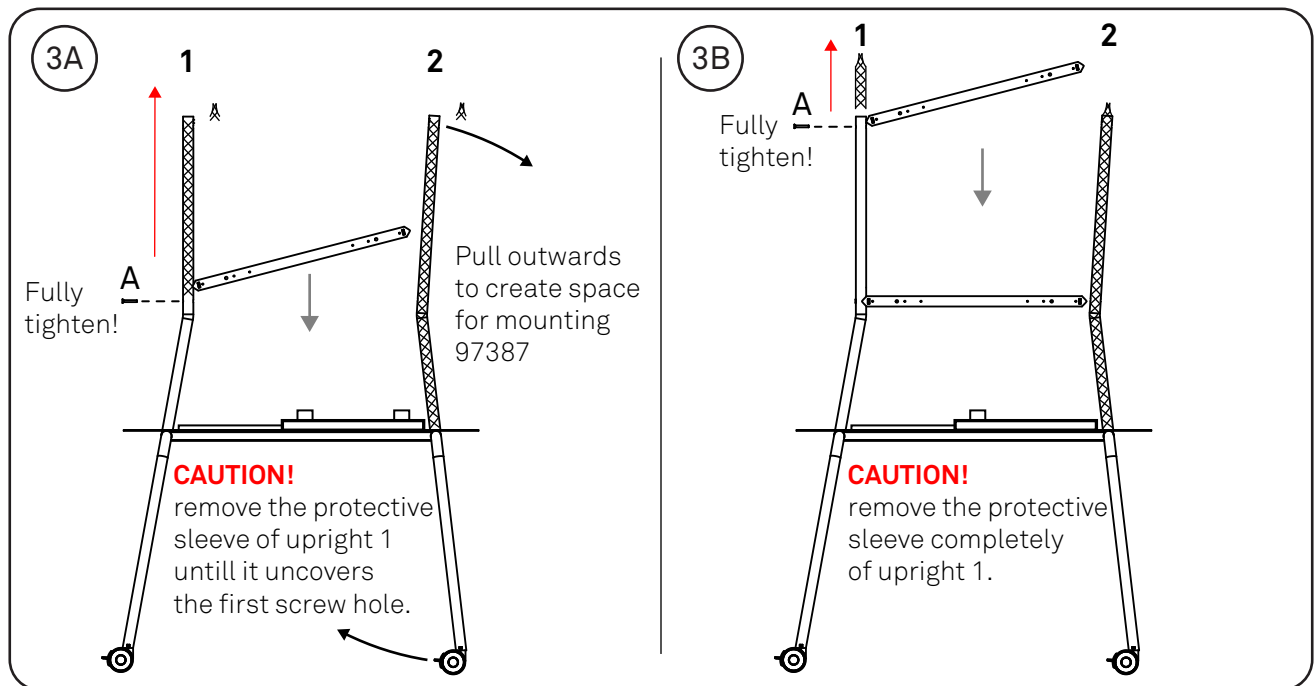



2x



Bolts:

4x M6*12mm
4x M6*25mm
4x M6*35mm
4x M8*12mm
4x M8*25mm
4x M8*45mm



Spacers:

4x 10mm
4x 5mm



Washers :

4x M6



Velcro :

50cm

Not included

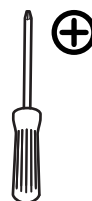

PH2

BE AWARE!:

Always read these safety instructions carefully before installing and using this product.

Following these instructions is strictly required. Incorrect mounting and/or installation could put you, your TV, and others at substantial risk.

Please consult the manual for your TV and ensure that the weight and size of the TV is within the

maximum weight and size limits specified for this product, and that the TV mounting bolts used are of a suitable length and diameter. Note that not all the TV mounting accessories provided are required for the installation of any one TV.

Cascando Products B.V. cannot be held responsible for any injury and/or damage caused by incorrect installation.

4

the shown dimensions below are only a indication of mounting patterns. These might vary with TV models and there respective heights.

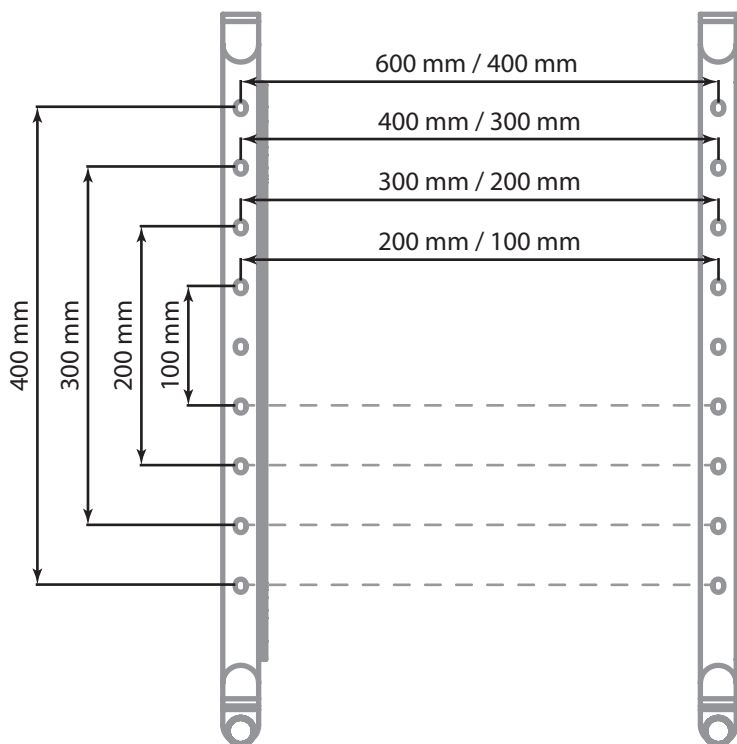

5

Place TV on top of a soft surface to prevent scratching.

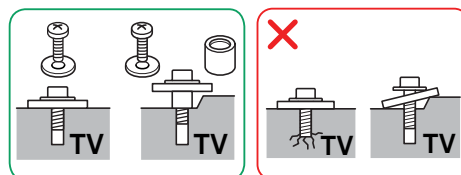

optional

